



“Better By Design”

Inverted Single Sided Studded Penetration Fittings

TECHNICAL DATA SHEET



Inverted studded penetration fittings include a flexible Acetal back plate that seals on flat or most curved surfaces down to 24” in diameter. These penetrations are secured with acetal molded stud nuts on the exterior of the sump. This eliminates having the stainless studs or nuts exposed to the soil. Boot material is injection molded UV resistant Thermoplastic. Assembly includes Series 300 all stainless steel clamps.

4 Stud penetrations are available in ¾” and 1” rigid conduit sizes.

①

8 Stud penetrations are available for 1.5” OD pipes through 3” nominal pipe.

②

10 Stud penetrations are available for 3” nominal pipe through 5.0” OD pipe. 10 Stud penetrations are also used on corrugated chase pipe.

③

12 Stud penetrations are available for 5.2” OD through 6” nominal pipe.

④

Series 300 stainless steel clamps and external stud nuts are provided with each penetration fitting.

Dimensional Data and Product Numbers on Reverse



Stainless Clamp and Stud Nuts are Included with Each Penetration

THIRD PARTY APPROVALS



EQ-742 EQ-801 EQ-836

PRODUCTS USED ON THIS PROJECT

Yes	No		
<input type="checkbox"/>	<input type="checkbox"/>	4 Stud Penetration Fitting	PF-4S-_____
<input type="checkbox"/>	<input type="checkbox"/>	8 Stud Penetration Fitting	PF-8S-_____
<input type="checkbox"/>	<input type="checkbox"/>	10 Stud Penetration Fitting	PF-10S-_____
<input type="checkbox"/>	<input type="checkbox"/>	12 Stud Penetration Fitting	PF-12S-_____
<input type="checkbox"/>	<input type="checkbox"/>	Clamp and External Stud Nuts	Included



Inverted Single Sided Studded Penetration Dimensional Data

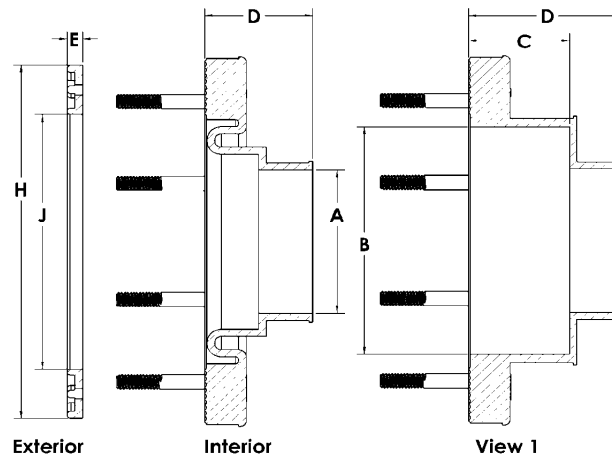

Part Number	A	B	C	D	E	H	J
PF-4S-1.1	1.200	N/A	N/A	1.625	0.250	4.467	3.282
PF-4S-1.3	1.300	N/A	N/A	1.625	0.250	4.467	3.282
PF-4S-1.4	1.390	N/A	N/A	1.625	0.250	4.467	3.282
PF-4S-41	1.450/1.100	N/A	N/A	1.625	0.250	4.467	3.282
PF-8S-1.5	1.500	N/A	N/A	1.625	0.250	6.375	5.282
PF-8S-1.6	1.625	N/A	N/A	1.625	0.250	6.375	5.282
PF-8S-1.7	1.725	N/A	N/A	1.625	0.250	6.375	5.282
PF-8S-1.9	1.950	N/A	N/A	1.625	0.250	6.375	5.282
PF-8S-2.0	2.050	N/A	N/A	1.625	0.250	6.375	5.282
PF-8S-2.2	2.190	N/A	N/A	1.625	0.250	6.375	5.282
PF-8S-2.4	2.450	N/A	N/A	1.625	0.250	6.375	5.282
PF-8S-2.5	2.550	N/A	N/A	1.625	0.250	6.375	5.282
PF-8S-2.7	2.725	N/A	N/A	1.625	0.250	6.375	5.282
PF-8S-2.9	2.900	N/A	N/A	1.625	0.250	6.375	5.282
PF-8S-3.0	3.030	N/A	N/A	1.625	0.250	6.375	5.282
PF-8S-3.3	3.300	N/A	N/A	1.625	0.250	6.375	5.282
PF-8S-3.6	3.600	N/A	N/A	1.625	0.250	6.375	5.282
PF-10S-3.6	3.600	N/A	N/A	1.660	0.250	8.000	6.875
PF-10S-3.8	3.800	N/A	N/A	1.660	0.250	8.000	6.875
PF-10S-4.4	4.380	N/A	N/A	1.660	0.250	8.000	6.875
PF-10S-4.5	4.550	N/A	N/A	1.660	0.250	8.000	6.875
PF-10S-4.6x2.0	2.010	4.600	2.200	2.500	0.250	8.000	6.875
PF-10S-4.6x2.5	2.250	4.600	2.200	2.500	0.250	8.000	6.875
PF-10S-4.8	4.780	N/A	N/A	1.660	0.250	8.000	6.875
PF-10S-5.0	5.050	N/A	N/A	1.660	0.250	8.000	6.875
PF-12S-5.2	5.168	N/A	N/A	1.780	0.250	9.250	8.062
PF-12S-6.3	6.350	N/A	N/A	1.780	0.250	9.250	8.062
PF-12S-6.7	6.675	N/A	N/A	1.780	0.250	9.250	8.062

Amount of DBBV or DEB Needed for Coverage

4 Stud Penetration	13 ml
8 Stud penetration	20 ml
10 Stud Penetration	24 ml
12 Stud Penetration	28 ml

Center to Center Diameter of Ext Plate Stud Holes

4 Stud	3.28
8 Stud	5.28
10 Stud	6.87
12 Stud	8.06

Hole Saw

4 Stud	2 ¼"
8 Stud	4"
10 Stud	5 ½"
12 Stud	6 7/8"