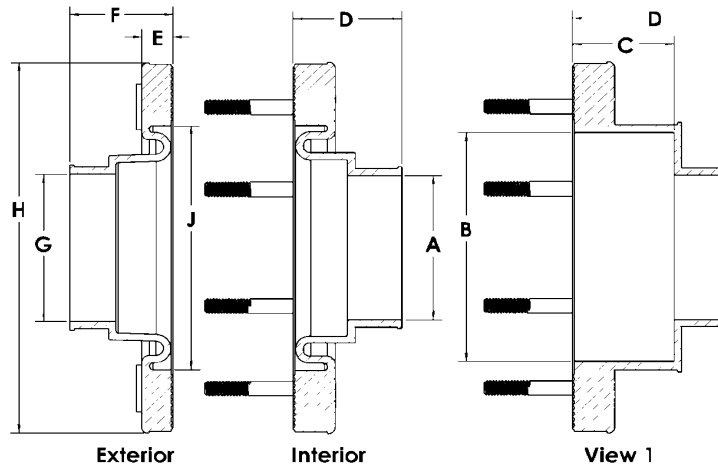

Inverted Double Sided Studded Penetration Dimensional Data

**NOTE:**

41 has one insert that reduces Dim A to 1.2"

419 has two inserts with second insert reducing Dim A to .9"

Part Number	A	B	C	D	E	F	G	H	J
PF-4D-1.1	1.200	N/A	N/A	1.625	0.500	1.625	1.200	4.467	N/A
PF-4D-1.3	1.300	N/A	N/A	1.625	0.500	1.625	1.300	4.467	N/A
PF-4D-1.4	1.390	N/A	N/A	1.625	0.500	1.625	1.390	4.467	N/A
PF-4D-41	1.450/1.100	N/A	N/A	1.625	0.500	1.625	1.450/1.100	4.467	N/A
PF-8D-1.5	1.500	N/A	N/A	1.625	0.500	1.625	1.625	6.375	3.600
PF-8D-1.6	1.625	N/A	N/A	1.625	0.500	1.625	1.625	6.375	3.600
PF-8D-1.7	1.725	N/A	N/A	1.625	0.500	1.625	1.725	6.375	3.600
PF-8D-1.9	1.950	N/A	N/A	1.625	0.500	1.625	1.950	6.375	3.600
PF-8D-2.0	2.050	N/A	N/A	1.625	0.500	1.625	2.050	6.375	3.600
PF-8D-2.2	2.190	N/A	N/A	1.625	0.500	1.625	2.190	6.375	3.600
PF-8D-2.4	2.450	N/A	N/A	1.625	0.500	1.550	2.450	6.375	3.600
PF-8D-2.5	2.550	N/A	N/A	1.625	0.500	1.750	2.550	6.375	3.600
PF-8D-2.7	2.725	N/A	N/A	1.625	0.500	1.750	2.725	6.375	3.600
PF-8D-2.9	2.900	N/A	N/A	1.625	0.500	1.750	2.900	6.375	3.600
PF-8D-3.0	3.030	N/A	N/A	1.625	0.500	1.750	3.030	6.375	3.600
PF-8D-3.3	3.300	N/A	N/A	1.625	0.500	1.750	3.300	6.375	3.600
PF-8D-3.6	3.600	N/A	N/A	1.625	0.500	1.800	3.600	6.375	3.600
PF-10D-3.6	3.600	N/A	N/A	1.660	0.500	1.698	3.600	8.000	4.800
PF-10D-3.8	3.800	N/A	N/A	1.660	0.500	1.698	3.800	8.000	4.800
PF-10D-4.4	4.380	N/A	N/A	1.660	0.500	1.698	4.380	8.000	4.800
PF-10D-4.5	4.550	N/A	N/A	1.660	0.500	1.698	4.550	8.000	4.800
PF-10D-4.6x2.0	2.050	4.650	1.640	2.380	0.500	1.698	4.800	8.000	4.800
PF-10D-4.6x2.5	2.550	4.650	1.640	2.380	0.500	1.698	4.800	8.000	4.800
PF-10D-4.8	4.780	N/A	N/A	1.660	0.500	1.698	4.780	8.000	4.800
PF-10D-5.0	5.050	N/A	N/A	1.660	0.500	1.698	5.050	8.000	4.800
PF-12D-5.2	5.168	N/A	N/A	1.780	0.500	2.150	5.168	9.250	6.675
PF-12D-6.3	6.350	N/A	N/A	1.780	0.500	2.150	6.350	9.250	6.675
PF-12D-6.7	6.675	N/A	N/A	1.780	0.500	2.000	6.675	9.250	6.675

Amount of DBB V or DEB Needed for Coverage

4 Stud Penetration Fitting	26 ml
8 Stud Penetration Fitting	40 ml
10 Stud Penetration Fitting	48 ml
12 Stud Penetration Fitting	56 ml

Center to Center Diameter of External Plate Stud Holes

4 Stud	3.28
8 Stud	5.28
10 Stud	6.87
12 Stud	8.06

Hole Saw

4 Stud	2 1/4"
8 Stud	4"
10 Stud	5 1/2"
12 Stud	6 7/8"